

Cabin assignment

Once BabyPhone Mobile is installed on a mobile device and all parameters have been set, a cabin phone can be assigned to the mobile device. The cabin phone will act as monitoring device, allowing to transmit the noise from the room to the mobile device.

Cabin assignment must be done by the front desk staff before handing over the mobile device to the passenger. If no cabin assignment is conducted, monitoring mode can only be [activated using a cabin phone](#).

There are two methods to assign a cabin phone to the mobile device. Which methods are available depends on the configuration of the [settings parameters](#).

Assignment by cabin number

If the parameter `start_monitoring_with_cabin_number` is set to true, the main screen of BabyPhone mobile will show a button labeled Enter Cabin Number. Press the button and enter the passenger's cabin number to assign the corresponding cabin phone to the mobile device.

No Cabin Assigned



Enter the cabin number

Your alarm history is empty

 ENTER CABIN NUMBER

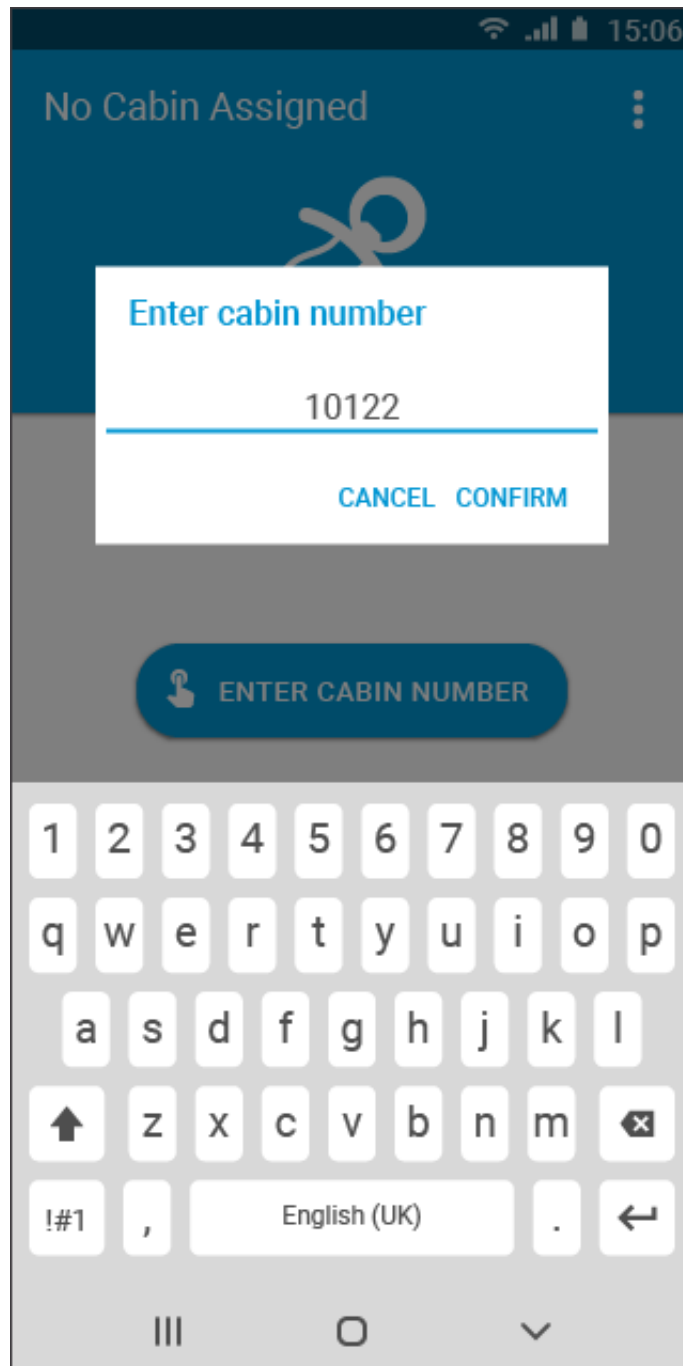

Assignment by QR code

If the parameter `start_monitoring_with_qr_code` is set to true, the main screen of BabyPhone mobile will show a button labeled Scan QR Code. The QR code for cabin assignment can be generated in the BabyPhone instance on Callisto by navigating to the tab [QR Code](#). In the search field, enter a cabin number or passenger name and select the passenger to assign to the mobile device from the search results. A QR code is generated automatically.

 **QR Code** BabyPhone



🔍 101|

Anna Hale 10122

Joseph Reed 10157

Cindy Campbell 10171

On the mobile device, press the button Scan QR Code and scan the QR code generated in Callisto to assign the corresponding cabin phone to the mobile device. After successful assignment, the QR code will display a green check mark.

No Cabin Assigned



Scan the QR code

Your alarm history is empty

 SCAN QR CODE

 **QR Code** BabyPhone



Anna Hale 10122

The information contained in the QR code is only the cabin number of the following format:

```
<?xml version = "1.0" encoding="utf-8"?>
<BabyPhoneConfiguration>
  <cabinNumber><cabin number></cabinNumber>
</BabyPhoneConfiguration>
```

This configuration data can be part of any other XML.

Statuses

The main screen will show the cabin number in the top left corner once the cabin phone is assigned

successfully. The colored top part of the screen indicates the current application status:

- Blue indicates that the application is properly set up and connected. From this status, BabyPhone Mobile can enter [monitoring mode](#).
- Green indicates that the application is currently in monitoring mode.
- Gray indicates that the device is either not connected to the network or that the SIP parameters are not configured correctly.

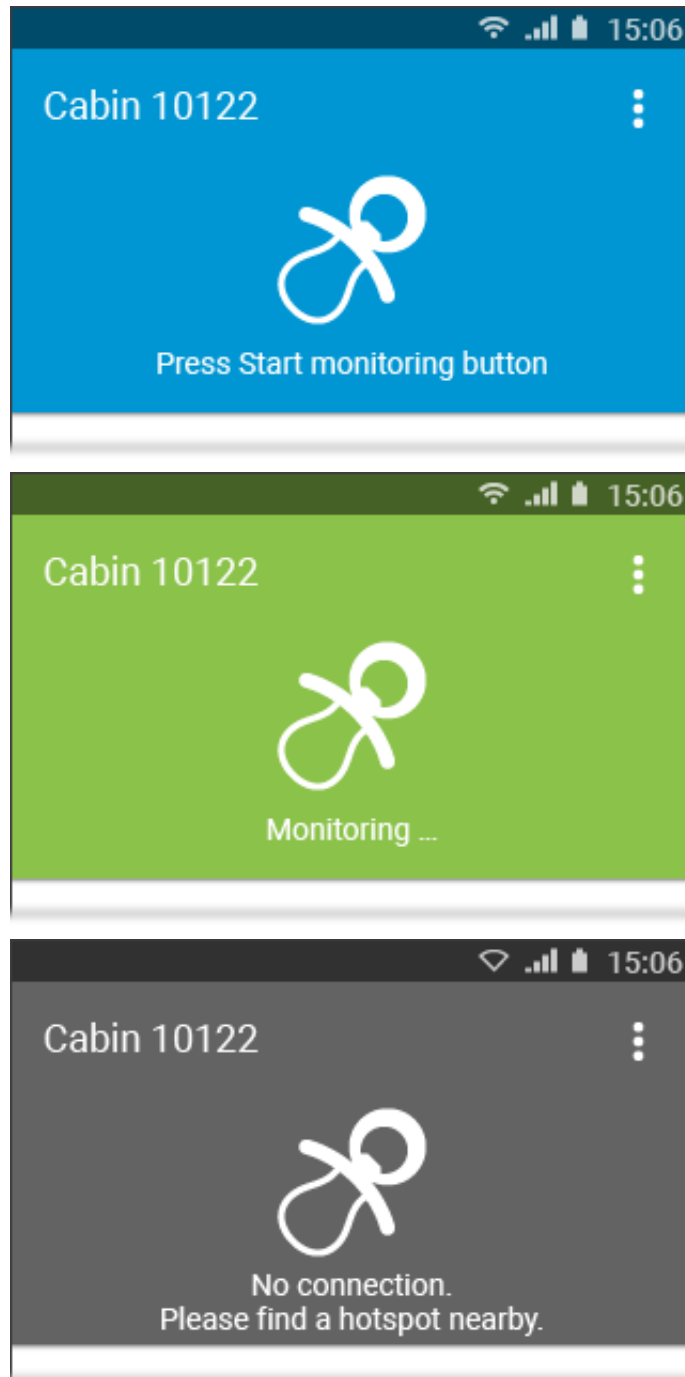

Reset cabin

After a guest returns the mobile device to the staff, a cabin reset must be performed before handing out the mobile device to another guest. Performing a cabin reset resets the assignment of the cabin phone and deletes the complete alarm call history.

To perform a cabin reset, touch the [main menu](#) button and select Reset Cabin. A window will pop up, prompting you to enter the reset PIN which is set in the [Callisto BabyPhone application](#). After a successful cabin reset, a text reading "No Cabin Assigned" is displayed in the top left corner of the mobile application's screen.

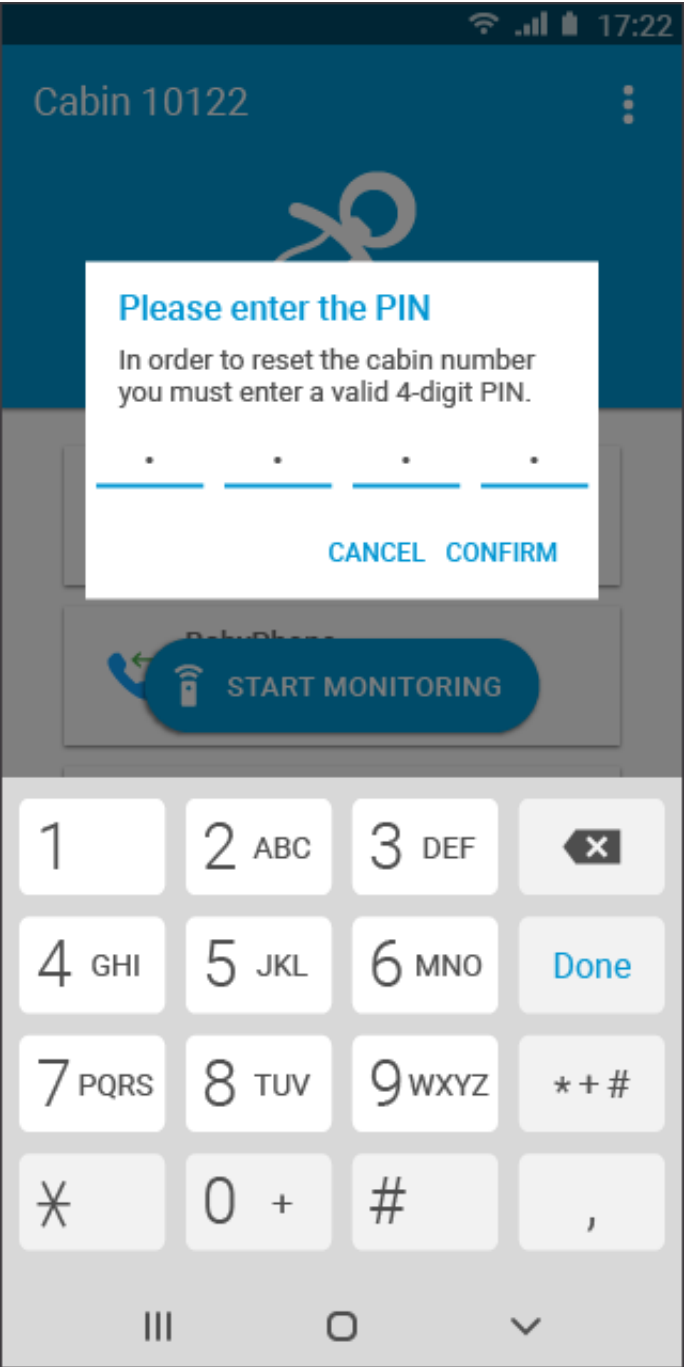

name which will be used as caller for babyphone calls

Reset PIN:

PIN wich will be used to reset the cabin number on the Android client

Automatically delete reports after (days):

The reset PIN can be found in the *Settings* tab of the BabyPhone instance on Callisto.